

# momentary switches



G

HEAVY DUTY PUSH-BUTTON SWITCHES	G1
MEDIUM DUTY PUSH-BUTTON SWITCHES	G2
TWO CIRCUIT PUSH-BUTTON SWITCHES	G3
MARINE CONSTRUCTION PUSH-BUTTON SWITCHES	G4
SPECIAL MOMENTARY SWITCHES	G5
FLEXIBLE CAPS FOR PUSH-BUTTON SWITCHES	G6
DOOR MOMENTARY SWITCHES	G7

## momentary switches

### G1 HEAVY DUTY PUSH-BUTTON SWITCHES

For applications to 36V DC. Off - On, Normally Off. On with button depressed, spring return to Off. Silver contacts. Chrome plated button and face nut (except where noted).

#### Cylindrical housing 35A at 12V, 20A at 24V DC.

9095 **BP** ★



Two screw terminals. Mounting stem: 5/8"-32 thread, 21/32" (16.7mm) long.

#### 9216 with Seal

Same as 9095, except with O-ring seal in the mounting stem.

#### 9216-03 with Seal and Screw-on Cap



Same as 9095, except with O-ring seal in the mounting stem, and screw-on black rubber protective cap (83280-03).

#### 9245 with Seal and Snap-on Cap **BP** ★



Same as 9095, except with O-ring seal in the mounting stem, snap-on black rubber protective cap (407-03), and black plastic button.

#### 90036-02 with blade terminals



Same as 9095, except with 2 blade terminals to fit Delphi (Packard) 2973407 two-way connectors, or similar.

#### 9244-02\* with Seal, Screw-on Cap, Stud Terminals

Same as 9095, except with O-ring seal in the mounting stem and screw-on black rubber protective cap (83280-03), two 10-32 stud terminals with hexnuts and lockwashers, and black plastic button.

CONTINUED **G1**

# G momentary switches

G1 HEAVY DUTY PUSH-BUTTON SWITCHES

## 9155\* with large button



15/16" diameter button. 2 screw terminals with lockwashers. Mounting stem: 5/8"-32 thread, 21/32" (16.7mm) long.

## 9231 with protected button ★



With recessed facenut designed to prevent accidental actuation. 2 screw terminals. Mounting stem: 5/8"-32 thread, 21/32" (16.7mm) long.

## 90000-01\* with protected button, and seal

Same as 9231, except with O-ring seal in the mounting stem.

## 90030 with plastic button, and screw-on cap BP ★



Two screw terminals. Mounting stem: 5/8"-32 thread, 21/32" (16.7mm) long. With screw-on black rubber protective cap 83280-03.

## 90030-01 with plastic button, and oil-resistant cap

Same as 90030, except with brown oil-resistant cap 83280-05.

## 90030-04 with plastic button, and red screw-on cap

Same as 90030, except with Red screw-on protective cap 83280-02.

## 90011\* with plastic button, and button terminals



Two male button head terminals, accept Delphi (Packard) connector 2962679, or equivalent. Mounting stem: 5/8"-32 thread, 5/8" (15.9mm) long. Accepts screw-on protective cap 83280-03. Black plastic button.

## Rectangular housing

10A at 12V DC, except where noted.

9044



2 screw terminals. Mounting stem: 5/8"-32 thread, 1.06" (26.9mm) long. Gasket seal in the case.

## 9044-02\* with cap

Same as 9044, but with screw-on black rubber protective cap 83280-03.

## 9023 ★



15A resistive, 10A inductive at 12V DC, 8A resistive, 5A inductive at 24V DC. Two screw terminals. Mounting stem: 5/8"-32 thread, .87" (22.1mm) long.

## 9023-09 with cap

Same as 9023, but with screw-on black rubber protective cap 83280-03.

## 9238 with blade terminals ★

Same as 9023, but with blade terminals.

## 9238-01 with blade terminals, and cap

Same as 9023, but with blade terminals and black rubber screw-on cap 83280-03.

## 9023-A\* with silver contacts

Same as 9023, but with silver contacts, giving greater voltage range – 6-36V DC. 15A at 12V, 8A at 24V, 4A at 36V DC.

## more moms

You'll find more moms (or momentary switches) in the following catalog sections:

- Rocker Switches – Section A
- Toggle Switches – Section B
- Ignition Switches – Section C
- Rotary Switches – Section D

★ Rapid ship item. BP Available in retail clamshell pack. ★ Minimum order quantity may apply.



Cole Hersee Co. 20 Old Colony Ave, Boston, MA 02127-2467

64

T 617.268.2100 F 617.268.9490 www.colehersee.com

**G2 MEDIUM DUTY PUSH-BUTTON SWITCHES**

9115 ★



Two screw terminals with lockwashers. Mounting stem: 5/8"-32, 7/8" thread (22.2mm) long.

**90028\***

Same as 9115, but with blade terminals.

**90002 sealed**

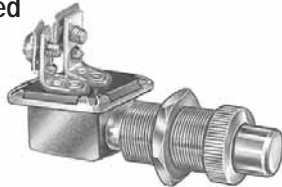

Weather-resistant and dust-resistant. Gasket-sealed case and O-ring in stem. Two screw terminals with lockwashers. Mounting stem: 5/8"-32 thread, 1 1/16" (26.9mm) long.

**90002-01 sealed, heavy-duty**

Same as 90002, except with silver contacts for heavy duty applications up to 36V DC.

**91126 PVC-coated**



PVC-coated body for moisture and dirt protection. Two 7" (177.8mm) wire leads. Mounting stem: 7/16"-20 thread, .44" (11.2mm) long. Steel button, .38" (9.7mm) diameter.

90043 sealed, with rubber cap ★



Two blade terminals accept 2-pole Delphi (Packard) connector 2977647 or equivalent. Mounting stem: 5/8"-32 thread, .625" (15.9mm) long. Gasket seal in the case. Steel plunger protrudes through the cap. Black rubber cap snaps into a special groove on the nut, which is deep-threaded and gives a positive seal.

90043-07 PVC-coated, sealed, with rubber cap ★



Same as 90043, except with PVC-coated body and two 7" (177.8mm) 18AWG wire leads.

9212

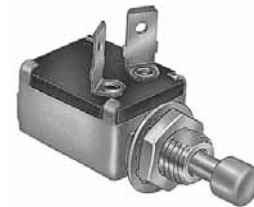

2 blade terminals. Mounting stem: 7/16"-20 thread, 1/2" (12.7mm) long. 1/2" (12.7mm) plunger with nylon cap.

# momentary switches

**G3 TWO CIRCUIT PUSH-BUTTON SWITCHES**

*Two circuits are simultaneously energized.*

**Normally Off**

*Off-On, normally Off. On with plunger depressed, spring return to Off.*

**9165 with screw terminals**



10A per circuit at 12V DC. Three screw terminals with lockwashers. Mounting stem: 5/8"-32 thread, 21/32" (16.7mm) long with two steel hexnuts and facenut.

9276\* with blade terminals, silver contacts



35A at 12V, 20A at 24V, 10A at 36V DC. Three blade terminals. Mounting stem: 5/8"-32 thread, 21/32" (16.7mm) long. Silver contacts for extra-heavy applications to 36V DC.

CONTINUED **G3**

★ Rapid ship item. BP Available in retail clamshell pack. \*Minimum order quantity may apply.

# G momentary switches

## G3 TWO CIRCUIT PUSH-BUTTON SWITCHES

### 9276-09 with protective cap



Same as 9276, but with three screw terminals and screw-on protective black rubber cap 83280-03, and with black plastic button.

### Normally On

*On-Off, normally On. Off with plunger depressed, spring return to On.*

9211

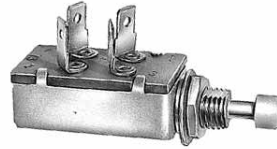

Commonly used in school bus stepwell and door control. Four blade terminals. Mounting stem: 7/16"-20 thread. .33" (8.4mm) diameter button. 10A per circuit at 12V DC.

# momentary switches

## G4 MARINE CONSTRUCTION PUSH-BUTTON SWITCHES

### Normally Off

*SPST. Off - Momentary On. On with button depressed, spring return to Off. Corrosion-resistant brass case, plunger button and mounting hardware. Moisture-repellent insulators. Chrome-plated buttons and facenuts, except where noted.*

### Extra Heavy Duty

*35A at 12V, 20 at 24V, 10A at 36V DC.*

M-490 BP ★



Two brass screw terminals. Mounting stem; brass 5/8"-32 thread, 1 3/8" (34.9mm) long, fits panels up to 1" (25.4mm) thick. Silver contacts.

M-626 with snap-on cap BP ★



Same as M-490, but with snap-on black rubber cap 407-03.

M-626-02 with screw-on cap ★



Same as M-490, but with screw-on black rubber cap 83280-03.

M-612 with recessed button BP



Same as M-490, but with recessed facenut, designed to prevent accidental actuation.

M-491 with large button BP



Same as M-490, but with large anodized aluminum button, 15/16" (23.8mm) diameter.

### Heavy Duty

*10A at 12V DC. For 6-36V DC applications.*

M-492 BP ★



Two brass screw terminals. Brass mounting stem 5/8"-32, 1 3/8" (34.9mm) long. Fits panels up to 1" (25.4mm) thick.

*M-492-01\**

Same as M-492 except with blade terminals.

★ Rapid ship item. BP Available in retail clamshell pack. ★ Minimum order quantity may apply.



Cole Hersee Co. 20 Old Colony Ave, Boston, MA 02127-2467

66

T 617.268.2100 F 617.268.9490 www.colehersee.com

### M-485 with 1" stem, and gasket BP ★



Two brass screw terminals. Brass mounting stem 5/8"-32, 1" (25.4mm) long. Fits panels up to 3/4" (19.1mm) thick. Gasket-sealed case.

### M-524 with snap-on cap

Same as M-485 except with snap-on black rubber cap 407-03.

### M-485-02

Same as M-485 except with screw-on black rubber cap 83280-03.

### M-608 PVC-coated BP ★



PVC-coated body sealed against moisture and dirt, with black rubber snap-on cap 407-03. Two 12" (304.8mm) 18AWG leads. Brass mounting stem 5/8"-32, 15/16" (23.8mm), fits panels up to 1/2" (12.7mm) thick.

## Normally On

*SPST. On - Momentary Off. Off with button depressed, spring return to On. Corrosion-resistant brass case and mounting hardware. Gasket-sealed case. 10A at 12V DC.*

### M-639 with chrome plunger



Chrome-plated brass plunger. Two brass screw terminals. Brass mounting stem 5/8"-32 thread, 1" (25.4mm) long. Fits panels up to 3/4" (19.1mm) thick.

### M-914-01 with nylon cap plunger



Two brass screw terminals. Brass mounting stem 3/8"-32 thread, 1" (25.4mm) long. Fits panels up to 3/4" (19.1mm) thick.



## marine construction

### 'Marine Construction' means 'for demanding applications'

Our marine construction switches are designed to stand up to conditions like ocean water spray that can destroy other switches. So these exceptional switches are also suitable for situations where dust infiltration and water spray can be a problem... like off-road equipment, agricultural vehicles, and other demanding applications.

Special features include rubber caps to protect the plunger, gasket-sealed cases (with rectangular housing switches), moisture-repellent insulators, brass construction, or chrome-plated brass, or the ultimate plasticized switch where the wire leads, body and part of the stem are dipped in a resilient PVC coating to completely seal the switch mechanism

## ignition



See Section C.

SPECIAL SWITCHES **G5**

★ Rapid ship item. BP Available in retail clamshell pack. ★ Minimum order quantity may apply.

# G momentary switches

## G5 SPECIAL MOMENTARY SWITCHES

For specific applications

### 9250 Momentary Windlass Switch



35A at 12V, 20A at 24V DC. Picture shows typical vertical mounting location. Mounting plate and diaphragm are not supplied. Off-Momentary On, spring return to Off. Brass case and mounting hardware. Silver contacts. Two brass screw terminals. Brass mounting stem 5/8"-32 thread, 7/16" (11.1mm) long, fits panels up to 3/16" (4.8mm) thick. Anodized aluminum button 15/16" (23.8mm) diameter. Plunger button is loose, and must be held in place with rubber diaphragm.

## Momentary Pull Switches

### M-486 normally Off



10A at 12V DC. Normally Off. Pull On, spring return to Off. Brass case and mounting hardware. Two brass screw terminals. Brass mounting stem 3/8"-32, 1 1/4" (31.8mm) long. Fits panels up to 7/8" (22.2mm) thick. Chrome-plated brass knob, debossed 'PULL', 7/8" (22.2mm) diameter. Moisture-repellent insulator.

### 9109 normally Off. Use with cable or lever



10A at 12V DC. Normally Off. Pull On, spring return to Off. Brass case and mounting hardware. Two screw terminals with lockwashers. Mounting stem 1/2"-20 thread, 5/8" (15.9mm) long. No knob: shaft has 3/32" (2.4mm) hole for the attachment of a cable or lever.

### 9071\* normally On. Use with cable or lever

Same as 9109, except Off with shaft pulled out. Pull Off, spring return to On.

## Horn Buttons

### 96101 surface mount BP ★



5A at 12V DC. Two screw terminals. Black plastic button, 13/16" (20.6mm) diameter.

### 96100 clamp mount



5A at 12V DC. Same as 96101, but with clamp that allows attachment on a steering column up to 1 1/2" (38.1mm) diameter.

### 96102 large button, clamp mount



5A at 12V DC. Two screw terminals. Ivory plastic button 1 3/4" (44.5mm) diameter. Clamp allows attachment on a steering column up to 1 1/2" (38.1mm) diameter.



give warning

Looking for a pilot light or audible warning to connect to your switch? See Section N1: Buzzers & Alarms, and Section N2: Pilot Lights.

★ Rapid ship item. BP Available in retail clamshell pack. ★ Minimum order quantity may apply.



## Engine Start/Engine Stop

**35A at 12V, 20A at 24V DC. Two screw terminals with lockwashers. Mounting stem 7.8"-24 thread, keyed to prevent switch from turning, fits panels .04" - .10" thick (1.0 - 2.5mm). Silver contacts.**

Impact-resistant molded plastic button with imprint, white on color, repels oil, water and other liquids. Diecast housing, with knurled aluminum facenut. 2 7/32"L x 1 1/8"D (50.8 x 28.6 x 3.18mm).

90047 with black 'Start' button ★

90047-01 with red 'Stop' button



90048 weatherproof with 'Start' imprint

Same as 90047, but with special facenut with built-in lip seal for added weather-resistance.

90048-01 weatherproof with 'Stop' imprint

Same as 90047-01, but with special facenut with built-in lip seal for added weather-resistance.

## Momentary Grounding Switches

**Self-grounding in metal panels. Contacts normally open. Contacts close (terminal to ground) with plunger depressed, spring return to open.**

9059 snap mount



5A at 12V DC. Chrome-plated brass button with chrome-plated faceplate. One bullet terminal. Snaps into 15/16" (23.8mm) diameter hole.

92118-06



5A at 24V DC. One blade terminal. Gasket-sealed case. 3/8" -24 UNF-2A thread, 1/4" long (3.18mm).

9035\*



10V at 12V DC. Chrome-plated button. One screw terminal with lockwasher. 5/8"-32 thread mounting stem, 7/8" long (22.2mm).

## Compact Design

**5A at 12V DC, except where stated. Normally Off is Push to Mom On, spring return to Off. Normally On is Push to Mom Off, spring return to On. Toggled type is Push to On, Push to Off.**

9075 Normally On ★



Snaps into .80 - .85" (20.3 - 21.6mm) diameter hole. Fits panels .03 - .07" thick (.76 - 1.8mm). Moisture-resistant molded plastic case. Two female bullet terminals, plastic plunger 9/16" (14.3mm) long.

Replaces: Delco 1972534, Ford B0A, B9a, B9MF, C3AZ, C5AZ, C607, FEW, OA-13713-A, Jeep 805699, Motorcraft SW-265, 395, Peterbilt 16-03030.

9100 Normally Off ★



6A at 125V, 3A at 250V. Push On, spring return to Off. For AC or DC. UL-approved. Plastic body, nickel-plated plunger. Two screw terminals. 15/32" -32 mounting stem, 9/16" (14.3mm) long.

CONTINUED G5

★ Rapid ship item. BP Available in retail clamshell pack. ★ Minimum order quantity may apply.

# G momentary switches

## G5 SPECIAL MOMENTARY SWITCHES

### 9011 Normally Off



Plated steel button, aluminum body. Two screw terminals, 7/8" -20 mounting stem, 3/8" (9.5mm) long.

### 9105 Toggled



10A at 12V, 5A at 24V. Two 6" (152.4mm) wire leads, 16AWG (1.00mm<sup>2</sup>). Phenolic body, 1.080"L x .530"W x 1.10"H (27.4 x 13.5 x 28.0mm). Push-button diameter .410" (10.4mm). Stem: .470" long (11.9mm). Can be used as a foot switch in dry environments.

### 9187 Normally Off, Black button **BP**



5A at 12V to 24V DC. Two blade terminals .250" wide (6.4mm). Nickel-plated brass hexnut and facenut. Nylon push-button, .410" diameter (10.4mm). Body size (to top of terminal): .890"L x .560"W x .773"H (22.6 x 14.2 x 19.6mm).

### 9187-01 Normally Off, White button **BP**

Same as 9187, except with white/natural nylon color button.

### 9187-02 Normally Off, Red button **BP**

Same as 9187, except with red button.

# momentary switches

## G6 CAPS FOR PUSH BUTTON SWITCHES

*Flexible caps give added resistance to weather and dust.*

### Threaded Caps

Rubber cap is permanently fastened to the integral mounting nut by a rolled brass bezel. The deep threaded 5/8"-32 aluminum mounting nut assures a positive seal. Durable, resilient rubber, embossed 'PUSH'. Fits Cole Hersee and all other push button switches with a 5/8"-32 thread mounting stem.

#### 83280-03 Black **BP**

#### 83280 Gray

#### 83280-02 Red



#### 83280-05 Oil-resistant

For use on fuel delivery trucks. Cap is molded from resilient Hydrin which provides excellent resistance to fuel oils. Brown color.

### Snap-on Caps

Ribs on the inside of the rubber cap engage with the switch facenut. Facenut – Section S2.

#### 407-03 Black **BP**

#### 407-01 Gray **BP**



★ Rapid ship item. **BP** Available in retail clamshell pack. ★ Minimum order quantity may apply.



## SPST Normally On

*Off with plunger depressed, spring return to On.*

### Without faceplate

9055 with 1/2" plunger



7/16" -20 thread mounting stem, 7/16" long (11.1mm), two flats on stem for mounting in double-D hole. Two screw terminals, plated steel case. 10A at 12V DC.

### 9055-02

Same as 9055 except with one hexnut and one pal nut.

9264 with 1/2" button end plunger



7/16" -20 thread mounting stem, 7/16" long (11.1mm), two flats on stem for mounting in double-D hole. Two screw terminals, plated steel case. 10A at 12V DC.

### 9264-02

Same as 9264 except with 7/8" (22.2mm) mounting stem. 10A at 12V DC.

### 9003



1/2" -20 thread mounting stem, 1/4" long (6.4mm), two screw terminals, 13/32" plunger (7.9mm). 5A at 12V DC

### With faceplate

9001 with screw terminals ★



Two screw terminals. Two 9/64" diameter (3.6mm) mounting holes, 1 3/8" (34.9mm) on centers. 45/64" diameter (17.9mm) plated steel case. Plunger: 7/16" long (11.1mm). 5A at 12V DC

### 9270 with blade terminals

Similar to 9001, but with two blade terminals.

### 9050-01 self-grounding

Same as 9001, but with one screw terminal.

### 9087 with screw terminals, four mounting holes BP



Four 3/16" diameter mounting holes, 1 3/8" and 2 1/16" on center (34.9, 51.0mm). 45/64" diameter (4.8mm) plated steel case. Plunger: 7/16" long (11.1mm). 5A at 12V DC.

### 9270-01 with sealed plunger, and wire leads



Two .144" (3.7mm) diameter mounting holes, 1 1/2" (38.1mm) on centers. 0.70" diameter (17.8mm) plated steel case. Plunger: 0.436" long (11.1mm). Black rubber cap on plunger, and PVC coating on 8" (203.0mm) wire leads protect against moisture and dirt. 5A at 12V DC.

### 9006 switch with boot BP ★



Black rubber boot covers and protects the face of the switch, making it dust-resistant. Plastic button. 4A at 12V DC lamp load. Two 2mm x 5mm blade terminals. 4A at 12V DC.

*International Trucks OEM replacement part 3579984C1 for trucks in these series: 2007, 4000, 7000, 8000, 9000.*

CONTINUED **G7**

★ Rapid ship item. BP Available in retail clamshell pack. ★ Minimum order quantity may apply.

# G momentary switches

G7 DOOR MOMENTARY SWITCHES

## SPST Normally Off

*On with plunger depressed, spring return to Off*

9002 with screw terminals



Two 9/64" (3.57mm) diameter mounting holes, 1 3/8" (34.9mm) on centers. 45/64" (17.9mm) diameter plated steel case. Two screw terminals. Plunger: 7/16" long (11.1mm). 5A at 12V DC.

9269 with screw terminals

Same as 9002, but with two blade terminals, and mounting holes 1 1/2" (38.1mm) on centers.

9004\* without faceplate

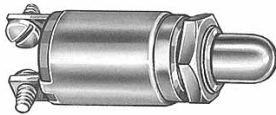

1/2" -20 thread mounting stem, 1/4" (6.4mm) long, two screw terminals, 13/32" (10.3mm) plunger. 5A at 12V DC.

## DPST Normally On

*Off with plunger depressed, spring return to On. For energizing two circuits simultaneously. Popular for use in school bus stepwell and door control. 10A at 12V DC*

9118 with screw terminals ★



7/16" -20 thread mounting stem, 7/16" (11.1mm) long, two flats on stem for mounting in double-D hole. Four screw terminals. Plunger 19/64" (7.54mm) long. 10A at 12V DC.

91801 with blade terminals ★

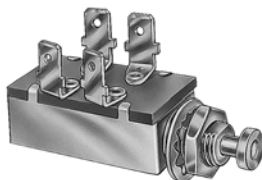

Same as 9118, except with four blade terminals. 10A at 12V DC.

9118-04 with long mounting stem

Same as 9118, except with 7/8" (22.2mm) long mounting stem and two hexnuts and one lockwasher. 10A at 12V DC.

91801-01

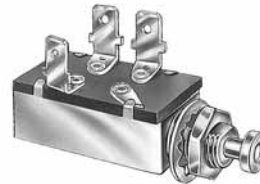

Same as 91801, except with one insulated, one grounded circuit and three blade terminals. 10A at 12V DC.

## DPST Normally Off

*On with plunger depressed, spring return to Off.*

9180

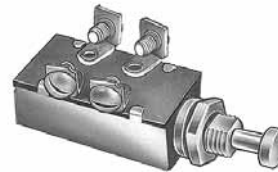

7/16" -20 thread mounting stem, 7/16" (11.1mm) long, two flats on stem for mounting in double-D hole. Four screw terminals, plunger 15/32" (11.9mm) long. 10A at 12V DC.

## School Bus Switches

*Designed for use in 8 light warning systems in school buses. 10A at 12V DC*

91811 two-circuit

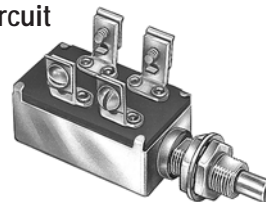

Normally On - Mom Off - Mom On. Two circuits. 7/16" -28 thread mounting stem, 3/4" (19.0mm) long, flat on stem for mounting in D hole. Four screw terminals, Plunger 23/64" (9.2mm) long. Extra-heavy duty. 10A at 12V DC.

91804 four-circuit DPDT

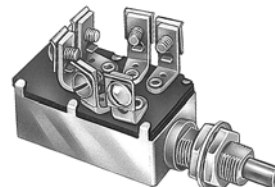

Normally On. Momentary Off. 7/16" -28 thread mounting stem, 3/4" (19.0mm) long, flat on stem for mounting in D hole. Six screw terminals, Plunger 23/64" (9.2mm) long. Extra-heavy duty. 10A at 12V DC.

★ Rapid ship item. BP Available in retail clamshell pack. ★ Minimum order quantity may apply.



Cole Hersee Co. 20 Old Colony Ave, Boston, MA 02127-2467

72

T 617.268.2100 F 617.268.9490 www.colehersee.com

**G7** DOOR MOMENTARY SWITCHES

91800 with stationary Off and momentary Off positions. 3 positions.

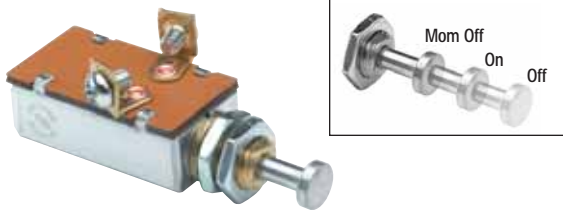

Normally On. Pull-out feature permits circuit to be shut off manually when the door must remain open and operation is not required. 7/16" -20 thread mounting stem, 7/16" (11.1mm) long. Two flats on stem for mounting in double-D hole. Two screw terminals. Plunger is 7/32" (5.6mm) long at On, 3/4" (19.0mm) at Off. 10A at 12V DC.

**91050 5-Circuit Door Switch**



For school bus door operation in conjunction with Cole Hersee relay 91052 (See Section M1). 7/16" -28 thread mounting stem, 7/8" (22.2mm) long. Eight blade terminals, plunger 5/16" (8.0mm) long. Silver-laminated contact surfaces. On position: door open, terminals 1&2, 5&7, 6&8 closed. Momentary On position: door closed, terminals 1&2, 7&9, 9&10 closed. Terminals 1&2 momentarily Open as plunger travels from On to momentary On, to reset the relay. Terminal 1 to relay, terminal 2 to ground, terminals 5&6 to red flashing lights, terminal 7&8 to flasher terminals, terminals 9 &10 to amber flashing lights. 10A at 12V DC.

power on, power off

Color-coded buttons make it easy to select On and Off functions. See Section G5.

**Normally grounded switches**

*Self-grounding in metal panels. Contacts Open with plunger depressed, spring return to Ground.*

**Single-circuit**

**91812**

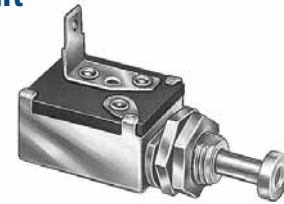

7/16" -20 thread mounting stem, 7/16" (11.1mm) long, two flats on stem for mounting in double-D hole. One blade terminal, plunger 33/64" (13.1mm) long. 5A at 12V DC.

**9266**



3/8" -24 self-tapping thread, mounting stem 5/16" (8.0mm) long. One female bullet terminal, plunger 5/8" (15.9mm) long, self-adjusting to 3/16" (4.8mm) long. Operates with 7lbs (3.2 kg) minimum pressure. 5A at 12V DC.

*Replaces: AMC 3662814, Chrysler 1971931, 1972329, 2770849, 2822592, 3843643, GMC 4891633, Motorcraft SW-518.*

**9251** ★



5/16" -18 self-tapping thread, mounting stem 1/2" (12.7mm) long. One female bullet terminal, plunger 7/16" (11.1mm) long, operates with 35oz (.99 kg) minimum pressure. 5A at 12V DC.

*Replaces: Chrysler 1571542, 1594751, 1688514, 1838957, GMC 4882978, 6276718, Motorcraft SW-690 (one terminal application).*

**91822**



3/8" -24 self-tapping thread, mounting stem 7/32" (5.6mm) long. One blade terminal, plunger 5/16" long, self-adjusting to 1/4" long. Operates with 6lbs (2.7 kg) minimum pressure. 3A at 12V DC.

*Replaces: GMC 9665205, 9839085, 20057138.*

CONTINUED **G7**

★ Rapid ship item. BP Available in retail clamshell pack. ★ Minimum order quantity may apply.

### Two-circuit

Two circuits grounded simultaneously. 5A at 12V DC

91823 ★



3/8" -24 thread, mounting stem 7/32" (5.6mm) long. Two blade terminals, plunger 3/16" (4.8mm) long, self-adjusting to 1/4" (6.4mm) long. Operates with 7lbs (3.2 kg) minimum pressure. 5A at 12V DC.

Replaces: AMC 3631896, 3662814, Chrysler 2497590, 2889084, GMC 9852254, 20603498, Motorcraft SWG-1115.

91840



1/2" -28 self-tapping thread, mounting stem 5/16" (8.0mm) long. Two blade terminals, plunger 3/4" (19.0mm) long, self-adjusting to 9/16" (14.3mm) long. 5A at 12V DC.

Replaces: Chrysler 4221254.

91843\*



3/8" -24 self-tapping thread, mounting stem .33" (8.38mm) long. Two blade terminals, plunger .85" (21.6mm) long, self-adjusting. 5A at 12V DC.

Replaces: GMC 20545277, 20591843.



## lockouts

Lockouts and tagouts prevent operators, technicians and maintenance personnel from unanticipated power-ups that might cause injury or death.

According to OSHA, "A lockout device utilizes a positive means such as a lock to hold an energy isolating device in a safe position and prevent the energization of a machine." A tagout is a tag or seal that states 'Do not operate or remove this tag' and is signed by the person who places the tagout. Procedures specify that nobody but that person may remove the tag.

A lockout on a battery switch not only keeps a vehicle safe, but also immobilizes it. A locked out vehicle is less vulnerable to battery drain or theft. See Section J4 for lockout kits.