

HOT FEED

Information on New Products from Cole Hersee Company

NEW

High-Amp Rotary Switch For Forward/Reverse Applications

Specially designed to operate tarps and winches on vehicles, and windlasses on boats.

Responding to demand, Cole Hersee now offers a 50A DPDT switch with heavy duty components that deliver continued reliability. Constructed with heavy gauge (3/32" thick) terminals and silver-laminated contacts to resist arcing over a long working life.

With three positions: Momentary On - Off - Momentary On, the switch is ideal for activating forward or reverse motion of a motor. With a tarping system the motion would be Cover/Uncover, with a hoist or tailgate, Up/Down, or with a windlass Raise Anchor/Lower Anchor.

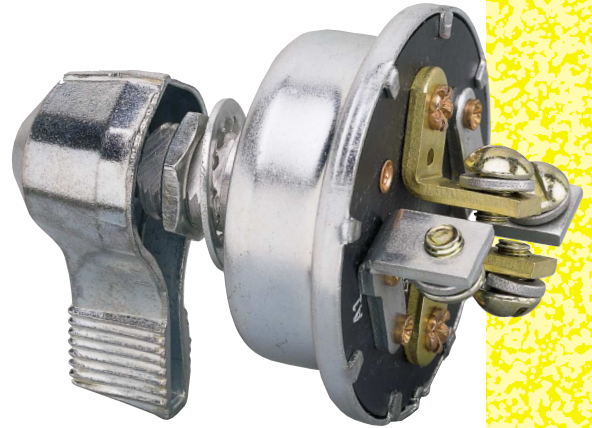

No. 75712-04

SPECIFICATIONS

- 50A at 12V DC
- Plated steel case, 2.09" (53.08mm) diameter.
- 4 screw terminals, No.10-32 x .375" (9.52mm) screws, with lockwashers.
- Silver-laminated contacts.
- Mounting stem: 1/2" -20 thread.
- (Left) Reverse On A1 & B1, A2 & B2 terminals, (Right) Forward On A1 & B2, A2 & B1.

OTHER COLE HERSEE REVERSING SWITCHES

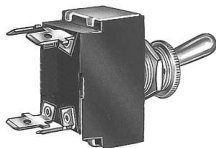

55046 25A Forward & Reverse Toggle Switch

DPDT. Momentary On - Off - Momentary On. Nickel-plated brass mounting stem 15/32" -32 thread fits panels up to 1/4" (11.90mm) thick. Nickel-plated brass handle, 11/16" (17.46mm) long, with nickel-plated brass facenut and hexnut. 4 blade terminals. Silver contacts. 25A at 12V DC.

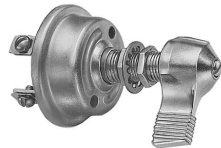

90005-01 15A Forward & Reverse Switch

DPDT. Momentary On - Off - Momentary On. (Left) Reverse On 1&4, 2&3, (Right) Forward On 1&3, 2&4. Long mounting stem: 1/2" -20 thread 1 1/4" long. Silver contacts. Four screw terminals. 15A at 12V DC.



90005-03 15A Forward & Reverse Switch with Keys

DPDT. Momentary On - Off - Momentary On. (Left) Reverse On 1&4, 2&3, (Right) Forward On 1&3, 2&4. Mounting stem: 13/16" -24 thread. Silver contacts. Four screw terminals. Coded tumbler lock with two keys, O-ring sealed at the stem. 15A at 12V DC.

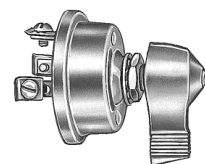

90005-04 15A Forward & Reverse Switch

DPDT. Momentary On - Off - Momentary On. (Left) Reverse On 1&4, 2&3, (Right) Forward On 1&3, 2&4. Mounting stem: 1/2" -20 thread. Silver contacts. Four screw terminals. 15A at 12V DC.



Cole Hersee Co.

20 Old Colony Avenue, Boston, MA USA 02127-2467 • (617) 268-2100 • Fax (617) 268-9490
See our interactive product catalog at www.colehersee.com